

ITEM NO.	JARVIS NO.	#	DESCRIPTION	QTY
3028 78241	1116940	101	NOSEPIECE HOUSING	1
3028 77461	1104539	102	NOSEPIECE LOCK WASHER	1
3028 36071	1104536	103	RED BUMPER WASHER	1
3028 77051	1171577	104	STUNNING ROD BUMPER	8
3028 77491	1104537	105	BLUE BUMPER WASHER	1
3028 77441	1120507	106	STUNNING ROD	1

PAS-PS Replacement Parts

PAS Type-P Specs:

- Penetrating Shaft Diameter: 0.45 inch (11.4 mm)
- Bolt Extension: 4.75 inches (121 mm)
- Control Handle, Single Trigger, Manual Operation
- Overall Dimensions: 11.25 X 1.875 X 7.47 in (286 x 48 x 191 mm)
- Weight: 6.20-lbs (2.8 kg)

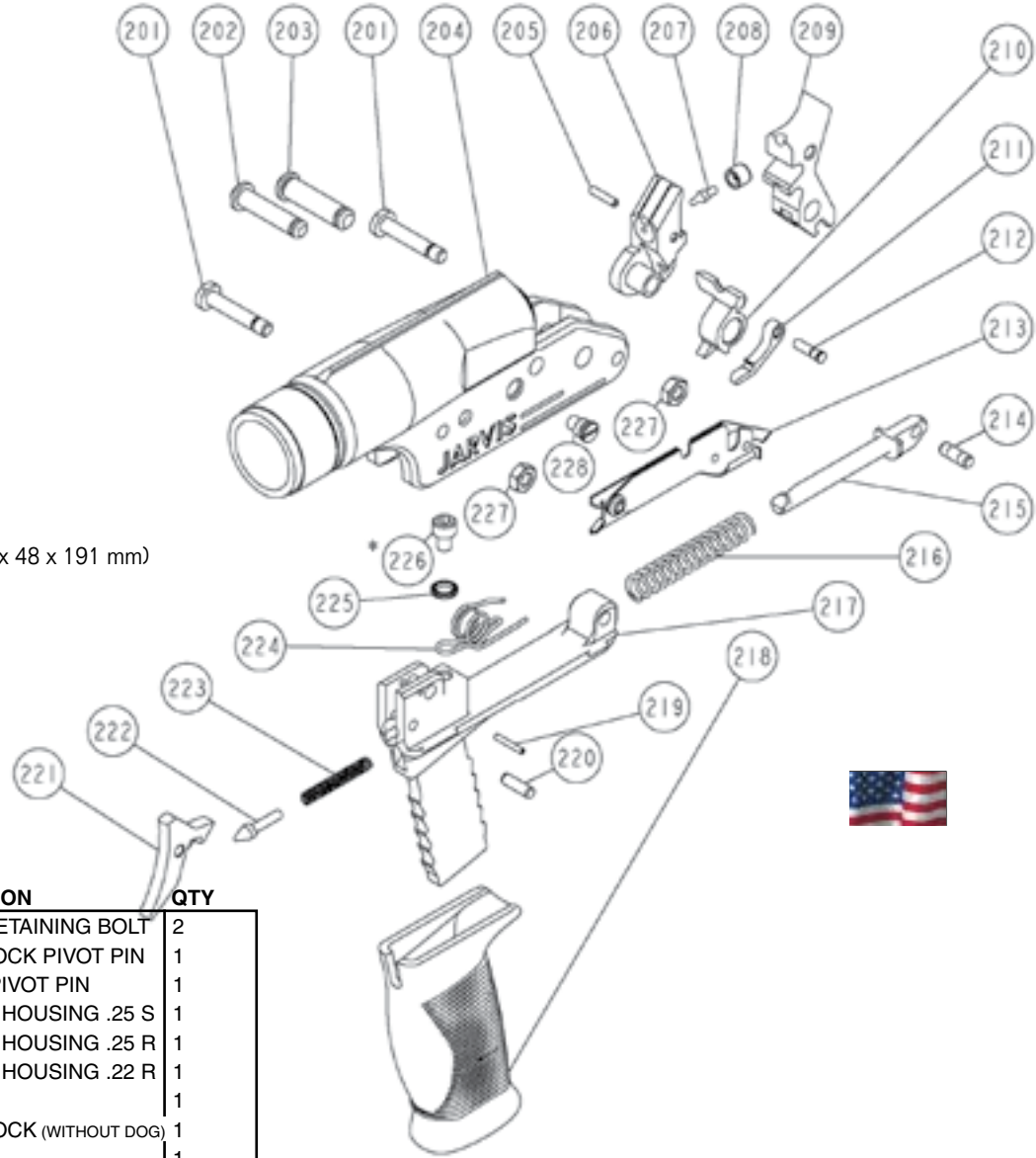

ITEM NO.	JARVIS NO.	#	DESCRIPTION	QTY
3028 77801	1154257	201	HANDLE RETAINING BOLT	2
3028 78301	1110616	202	FIRING BLOCK PIVOT PIN	1
3028 78261	1110618	203	HAMMER PIVOT PIN	1
3028 37171	3116603	204C	RECEIVER HOUSING .25 S	1
3028 36761	3116602	204B	RECEIVER HOUSING .25 R	1
3028 37181	3116601	204A	RECEIVER HOUSING .22 R	1
3028 78361	1110250	205	ROLL PIN	1
3028 36771	3161001	206	FIRING BLOCK (WITHOUT DOG)	1
3028 78161	1110617	207	FIRING PIN	1
3028 78371	1136001	208	FIRING BLOCK BUSHING	1
3028 36781	1118182	209	HAMMER	1
3028 77601	1171582	210	EXTRACTOR .25	1
3028 77711	1171579	210A	EXTRACTOR .22	1
3028 77941	1118181	211	DOG	1
3028 78171	1145030	212	DOG RIVET	1
3028 77661	3132042	213	CATCH PLATE ASSEMBLY	1
3028 78281	1110620	214	RELEASE PIN DOWEL	1
3028 77671	1110619	215	RELEASE PIN only	1
3028 77511	1114253	216	RELEASE PIN SPRING	1
3028 78781	1119301	217	HANDLE	1
3028 77841	1102775	218	HANDLE COVER	1

ITEM NO.	JARVIS NO.	#	DESCRIPTION	QTY
3028 78491	1110239	219	ROLL PIN	1
3028 78451	1110633	220	TRIGGER PIVOT PIN	1
3028 77921	1118183	221	TRIGGER	1
3028 78441	1110621	222	TRIGGER PIN	1
3028 78381	1114251	223	TRIGGER RETURN SPRING	1
3028 77381	1114252	224	EJECTOR SPRING	1
3028 78551	1104001	225	RIBBED LOCK WASHER (PAIR)	1
3028 78561	1173289*	226	SOCKET HEAD CAP SCREW	1
3028 77951	1107493	227	HEX NUT	2
3028 78621	1154258	228	TRIP SCREW	1
3028 36501	3110009	214/215	RELEASE PIN ASSEMBLY	1
3028 36791	3161561	205-208, 211-12	FIRING BLOCK & DOG ASSEMBLY	1
3028 36161	3110001	205, 207, 208	FIRING PIN ASSEMBLY	1

ITEM NO.	JARVIS NO	STANDARD REPLACEMENT PARTS AVAILABLE
3028 77781	1114254	216-S STANDARD RELEASE PIN SPRING
3028 77701	3110010	214S/215S STANDARD RELEASE PIN ASSEMBLY
3028 78151	1110622	214-S STANDARD RELEASE PIN DOWEL
3028 78201	1118002	209-S STANDARD HAMMER